

FLOW 12
FLOW 13

bench mounted basins



Flow 12



Flow 13

Manufactured by

simas
ACQUA SPACE

2.20.3

1 May, 2010

FLOW 12

FLOW 13

bench mounted basins



Flow 12

A rectangular bench mounted basin with soft curved edges. The basin is able to be used with wall or bench mounted tapware.

Flow 13

An oblong bench mounted basin with soft curved edges. The basin is able to be used with wall or bench mounted tapware.

Code Flow 12: SM FL12/A

Code Flow 13: SM FL13/A

Tap Hole options

No tap hole only.

Waste Outlet

32mm standard plug & waste to be ordered separately (see technical data sheets 2.80.0 for options).

Bowl Capacity

Flow 12 - 6 litres.

Flow 13 - 6.5 litres.

Overflow

N/A.

Fixing / Brackets

N/A.

Installation Instructions

It is recommended that the basin be installed using a flexible sealant. (Epoxy type glues must not be used. To do so may void product warranty). For ease of cleaning it is suggested that the minimum distance between the wall and the rear of the basin be 50mm.

Colour

White only

Packing Details

Flow 12 - 9.5kg. Flow 13 - 9kg. Supplied in one carton.

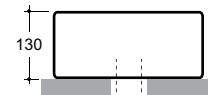
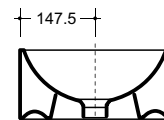
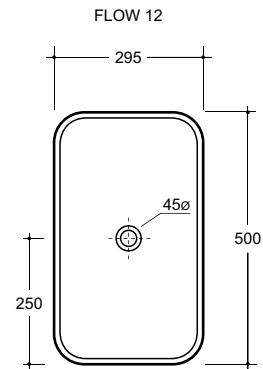

FLOW 13

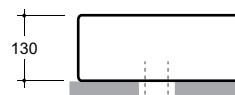
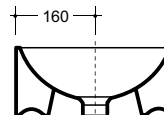
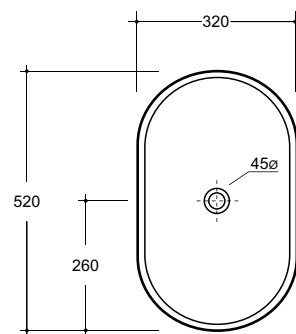

Manufactured by

